

## R & J Custom Furnishings ~ Cabinet Component Basics

Sturdy 1/4" to 3/4" back panel in either solid wood or melamine/veneer combo, depending on structural application needs and customer desires.

Instead of plastic corner bracings, we typically use a 4" bracing runner rail in the front and rear for increased stabilization.

Full length anchoring rails for solid, secure base or hanging cabinet installation.

Door and drawer fronts are 100% solid wood and completely custom designed per our customer's unique requests.

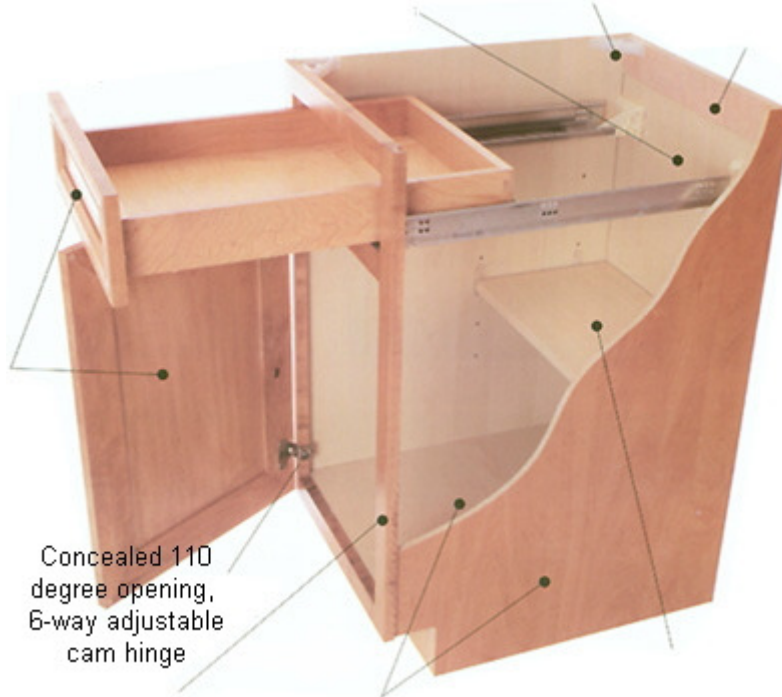

Concealed 110 degree opening, 6-way adjustable cam hinge

Our custom face frames are 3/4" x 1 1/2" or 3/4" x 2" solid wood depending on the application and customer design preferences.

1/2" laminated wood is standard on end panels and cabinet bottoms/tops. Alternatively, we use 3/4" melamine, veneer, or hard wood depending on the application requirements.

Adjustable half-shelf shown above. Options also include an adjustable full shelf, a fixed (stationary) full or half shelf, or a sturdy full pull-out shelf.

### At R & J Custom Furnishings, "Custom" Does Not Necessarily Mean "Expensive"

Installing kitchen cabinets of poor quality may save you a few dollars up front but it can potentially cost an untold amount of repair costs in the long run. Consider your cabinets to be the "base" structure of your kitchen. If they collapse, become susceptible to water damage, fall off of the hanging wall, or fold under the pressure of countertops and cookware, it could potentially cost thousands of dollars to repair all the affected areas of your kitchen. It is also probable that some of those expensive repairs will not be covered under manufacturer warranty for failed craftsmanship.

Before installing one-size-fits-all cabinets in your home, **call R & J Custom Furnishings for a free in-home quote!** Our quality kitchen cabinets start with sturdy designs, reliable frame materials, highly skilled craftsmanship, and superior customer service. We would love you help you transform your kitchen and bathroom dreams into a beautiful reality.

We also specialize in stunning Solid Surface countertops that offer the same strength and appeal of Granite, but without the troublesome repair flaws and higher price tags. Because of our low overhead and strong relationships with our suppliers, we can proudly offer our valued customers a seemingly endless combination of custom designs and materials to fit almost any budget. The possibilities are endless!

**R & J Custom Furnishings ~ Phone: 208-880-2981**  
RJsCustomFurnishings@yahoo.com  
www.IdahoSolidSurface.com